

2

1

30090E3.5X304 XX/XX

TUBE DIAMETER  
 BEND ANGLE  
 E  
 BEND CLR  
 X  
 MATERIAL  
 SPACE  
 OPTIONAL SUFFIX FOR END FINISHING

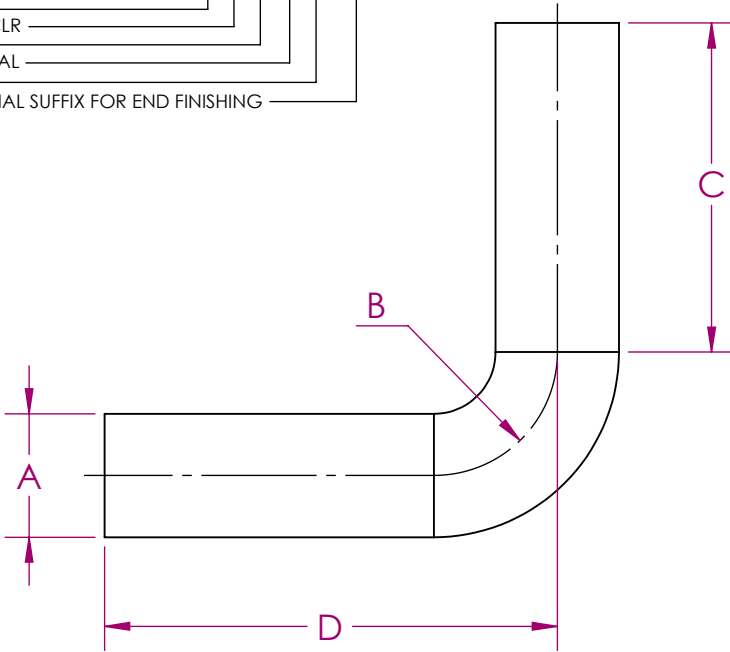

END FINISHING OPTIONS

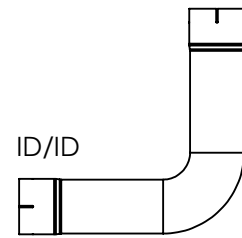
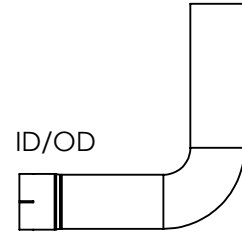

B

B

A	B	C	D	ALZ - 16GA	ALZ - 14GA	304SS	316SS	409SS
1	1	6	7	10090E1XAL		10090E1X304		
1.25	2	6	8	12590E2XAL		12590E2X304		
1.5	2	6	8	15090E2XAL		15090E2X304		
1.75	2	6	8	17590E2XAL		17590E2X304		
2	2	8	10	20090E2XAL		20090E2X304		
2	2.5	8	10.5	20090E2.5XAL		20090E2.5X304	20090E2.5X316	
2.25	2.25	8	10.25		22590E2.25XAL 14GA	22590E2.25X304		
2.25	3	8	11		22590E3XAL 14GA	22590E3X304		
2.5	2.5	8	10.5	25090E2.5XAL		25090E2.5X304		
2.5	3	8	11	25090E3XAL		25090E3X304		
2.75	2.75	8	10.75		27590E2.75XAL 14GA	27590E2.75X304		
2.75	3	8	11		27590E3XAL 14GA	27590E3X304		
2.75	4	8	12		27590E4XAL 14GA	27590E4X304		
3	3	12	15	30090E3XAL		30090E3X304		
3	3.5	12	15.5	30090E3.5XAL		30090E3.5X304	30090E3.5X316	30090E3.5X409
3	4.5	12	16.5	30090E4.5XAL		30090E4.5X304	30090E4.5X316	
3.5	4	12	16	35090E4XAL	35090E4XAL 14GA	35090E4X304		35090E4X409
3.5	6	12	18	35090E6XAL		35090E6X304		
4	4.5	12	16.5	40090E4.5XAL	40090E4.5XAL 14GA	40090E4.5X304	40090E4.5X316	40090E4.5X409
4	6	12	18	40090E6XAL		40090E6X304		40090E6X409
4.5	4.5	12	16.5	45090E4.5XAL				
5	5	12	17	50090E5XAL		50090E5X304		50090E5X409
5	6	12	18	50090E6XAL		50090E6X304		50090E6X409
6	6	14	20	60090E6XAL		60090E6X304		60090E6X409

A

A

2

1